

LOAD CELLS AMPLIFIER

The device is a signal amplifier for load cells and extensometers typically applied on Knuckle boom Cranes, Mobile Cranes, Tele-handler, Ship-to-shore Cranes, Harbour and Lattice Boom Cranes and Overhead travelling Cranes.
ACC-JB has also two connectors typically used for Anti two block systems applied on Winches.



ELECTRICAL CHARACTERISTICS:

- Power Supply: +12V : +24V DC
- Wheatstone Bridge Supply: 8 V DC
- Input signal: Typical 0 – 20mV DC
Max 0 – 200mV DC
- Output Signal 0V - 5V DC
- Gain :
setting by trimmer R2 from 20 to 400
- Offset :
setting by trimmer R4 from 0,3 to 0,6V

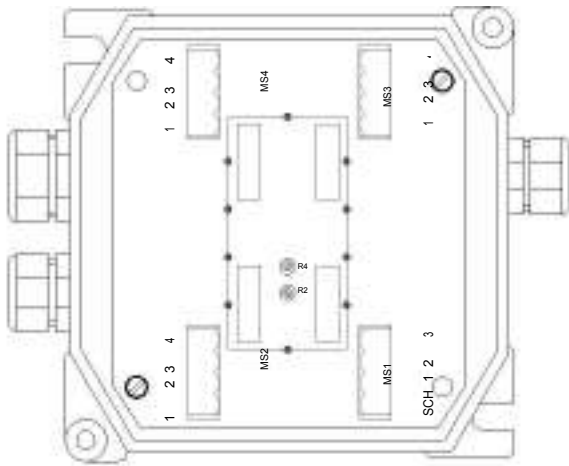

MS1	SIGNAL	MS2	SIGNAL	MS3	SIGNAL	MS4	SIGNAL
1	OUT	1	IN L	1	JB1	1	JB1
2	GND	2	IN H	2	JB2	2	JB2
3	+VB	3	+VA	3	JB3	3	JB3
	SCH	4	GND	4	JB4	4	JB4

MECHANICAL DIMENSIONS

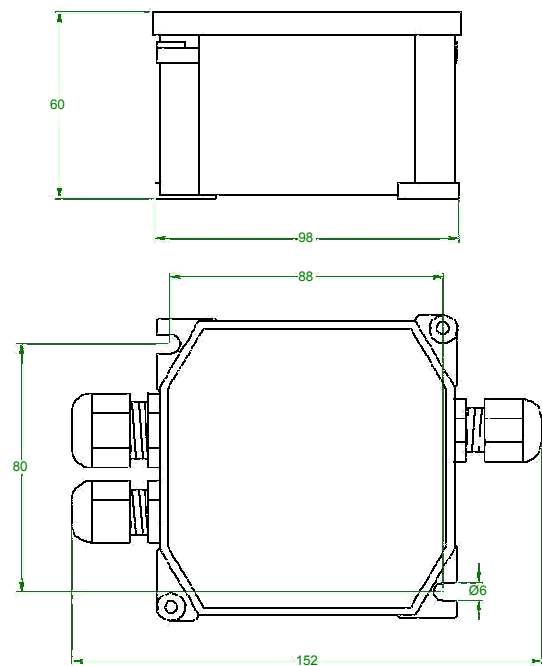

MECHANICAL CHARACTERISTICS

- Aluminium Box.
- Protection Class :
IP65 with board not sealed
IP67 with board sealed.
- Connection by PG and internal connectors.
- Operative Temperature Range: -25°C to +70 °C
- Storage Temperature Range : -35°C to + 85°C